



Ultra-Low Torque Wrench Link Attachment

The HTL Ultra-Low Torque Wrench Link Attachment is part of HTL's innovative 3-in-1 Hydraulic Torque Wrench range. Due to its innovative design and the high quality materials used, this tool is extremely durable and easy to operate. With both ring and open end spanner attachments available providing various hex sizes ranging from 3/4" to 4 5/8" AF (19mm to 120mm AF) and torque ranges from 255 to 13400 ft.lb (346 to 18165 Nm), the HTL Ultra-Low Torque Wrench Link Attachment is suitable for a wide range of applications even on the most confined applications.

Interchangeable and Cross Compatible

The 3-in-1 range ensures that the operator can interchange tools and links with many other well-known brands (specifically Hytorc, Rapid-Torc and Atlas Copco).

Please note a complete HTL Ultra-Low Torque Wrench is made up of a HTL Torque Wrench and HTL Ultra-Low Torque Wrench Attachment, each are sold separately.

Features and Benefits

- ✓ Fully interchangeable with many other brands
- ✓ Made in the UK
- ✓ Calibrated and Accurate to +/- 3%
- ✓ Only 1 moving part for reliability and maintenance
- ✓ Convert to a Low Profile or Square Drive tool in seconds
- ✓ Ring and Open end spanner attachments available
- ✓ None standard sizes manufactured to your spe
- ✓ Supplied with link pin retainer
- ✓ Ergonomic, adjustable torque wrench handle



Technical Information

Model		HTL-W2 & HTL-R2	HTL-W4 & HTL-R4	HTL-W8 & HTL-R8	HTL-W14 & HTL-R14
Torque wrench		HTL-2	HTL-4	HTL-W8	HTL-W14
Min Torque	Ft-lbs	255	580	1143	2010
	Nm	346	786	1549	2725
Max Torque	Ft-lbs	1710	3855	8151	13400
	Nm	2318	5226	11049	18165
Weight	Kg	2.2	3	3.3	8.2
A	mm	155	208	260	349
	Inch	6.1	8.1	10.2	13.7
B	mm	129	168	209	239
	Inch	5.1	6.6	8.2	9.4
C	mm	66	87	108	132
	Inch	2.6	3.4	4.3	5.1
D	mm	32	42	53	64
	Inch	1.2	1.7	2.1	2.52
E	mm	Dependent on A/F	Dependent on A/F	Dependent on A/F	Dependent on A/F
	Inch	Dependent on A/F	Dependent on A/F	Dependent on A/F	Dependent on A/F
F	mm	19	25.4	31.75	39
	Inch	0.7	1	1.25	1.5
G	mm	7.5	7.5	13	17.5
	Inch	0.3	0.3	0.5	0.7

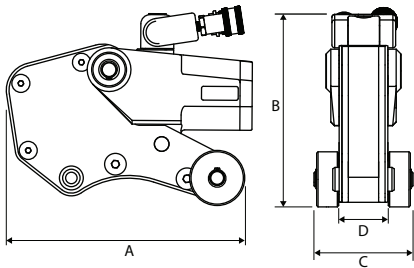

Tool Body

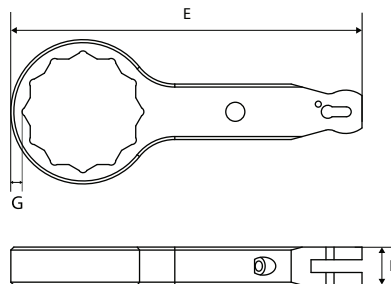

Ring End Spanner

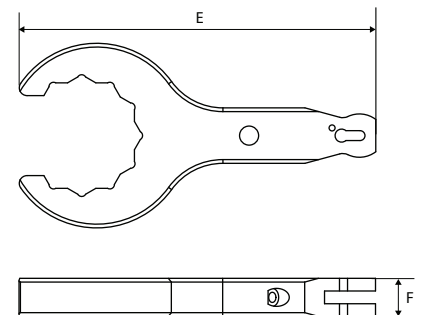

Open End Spanner

INDUSTRY LEADERS IN CONTROLLED BOLTING SOLUTIONS



OFFSHORE TOOLING
& SERVICES PTY LTD

Telephone: 0408 995 612

Email: sales@offshorettooling.com.au

Visit: offshorettooling.com.au